



# Interior Signage Standards

## 12/9/2019

**General Note:** Provide alternate deduct to replace all zinc panels with acrylic panels and associated text and graphics.



Matte White  
Finish  
Recessed

SW7006 Extra White



MP584  
Finish  
Raised

Pantone Cool Gray II



MP643  
Finish  
Raised



M3 = Aluminum, with etched and painted infilled text



M4 = Zinc, with reverse etched (integral raised) ADA-compliant text and Grade II Braille with all surfaces painted as specified.

## **SIGN A1 – General Signage**

**(Mechanical, Mother’s Room, Telecom Closet, Electrical Room, Etc.)**

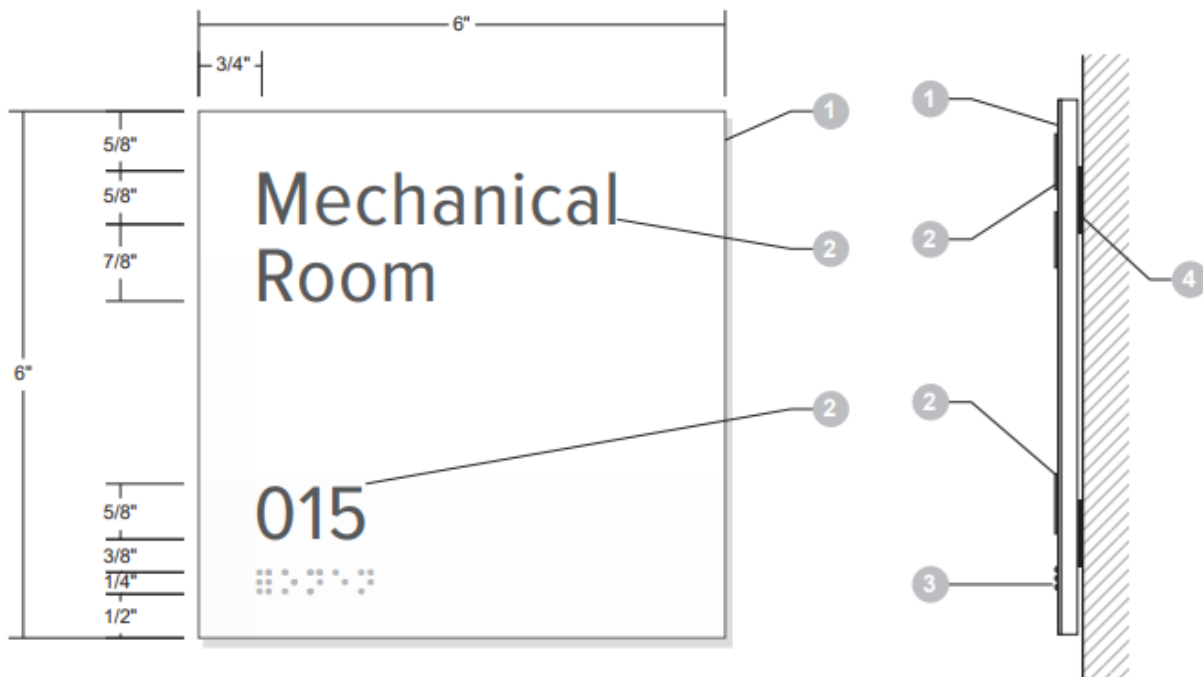

### **Sign A1 Specifications:**

1. Room Name and Number Panel: 1/16"-thick zinc panel with integral 1/32"-raised reverse etched text, graphics, and Grade II Braille; laminated to 3/16"-thick aluminum slab carrier. Sign surface and returns painted P1.
2. Raised text and graphics painted P2 on face of graphics only.
3. Integral Grade II Braille painted P1.
4. Sign mounts to wall surface with 3M VHB tape and silicone adhesive.

\*Provide full-scale sample of the above sign.

## **SIGN A2 – Office/Room Suites**

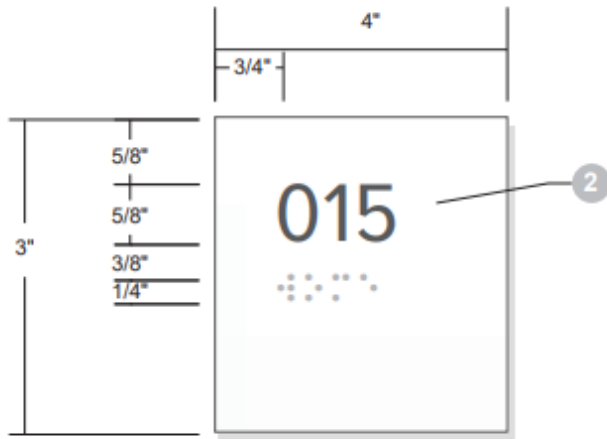

## **SIGN A3 – Max Occupancy Signs**

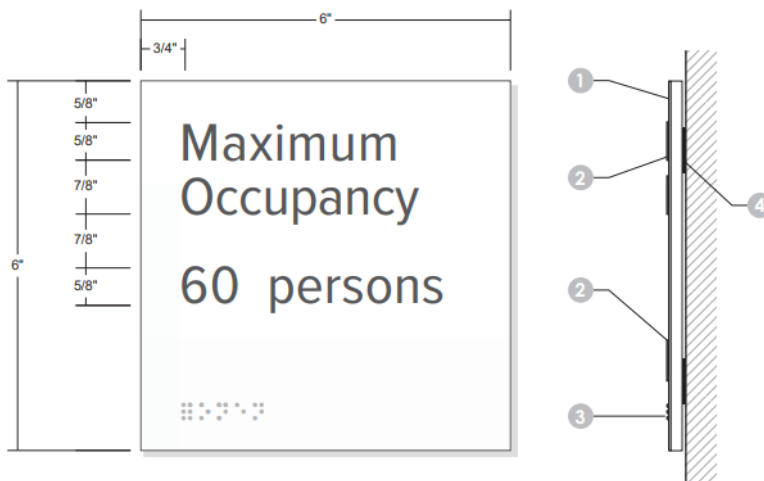

## **Sign A2 & A3 Specifications:**

1. Sign Panel: 1/16"-thick zinc panel with integral 1/32"-raised reverse etched text, graphics, and Grade II Braille; laminated to 3/16"-thick aluminum slab carrier. Sign surface and returns painted P1.
2. Raised text and graphics painted P2 on face of graphics only.
3. Integral Grade II Braille painted P1.
4. Sign mounts to wall surface with 3M VHB tape and silicone adhesive.

**SIGN B1 - Typical Office Sign**

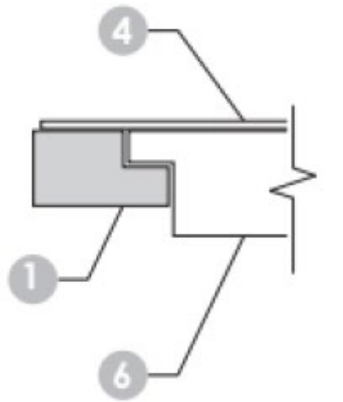

**PLAN SECTION DETAIL**  
SCALE: 12" = 1'

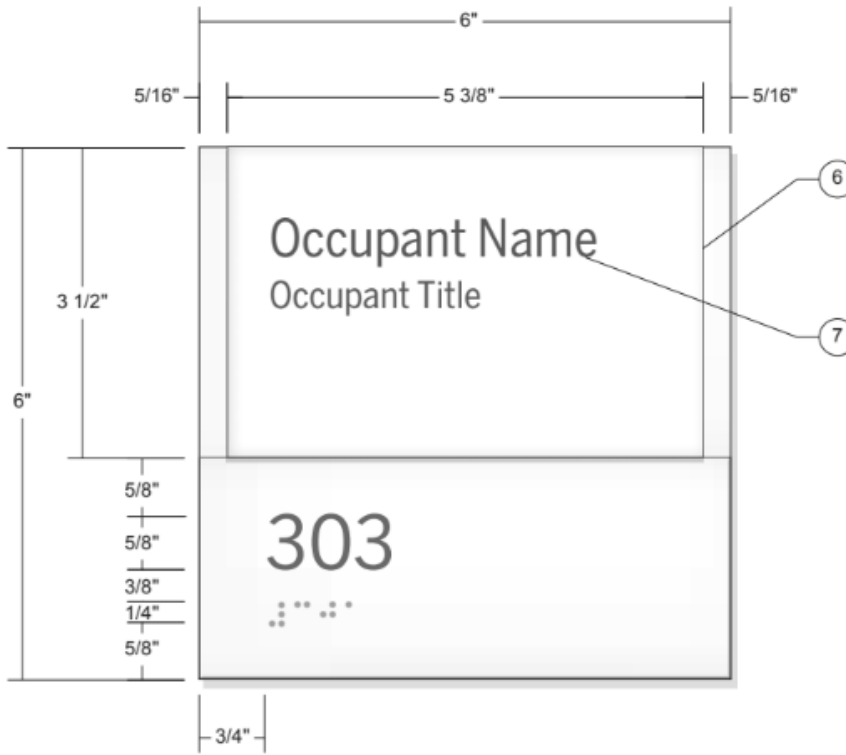
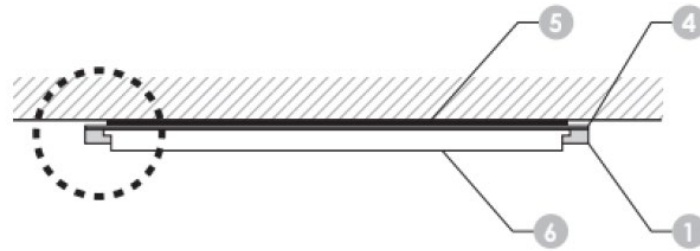

**OFFICE ID: Elevation**  
SCALE: 6" = 1'-0"

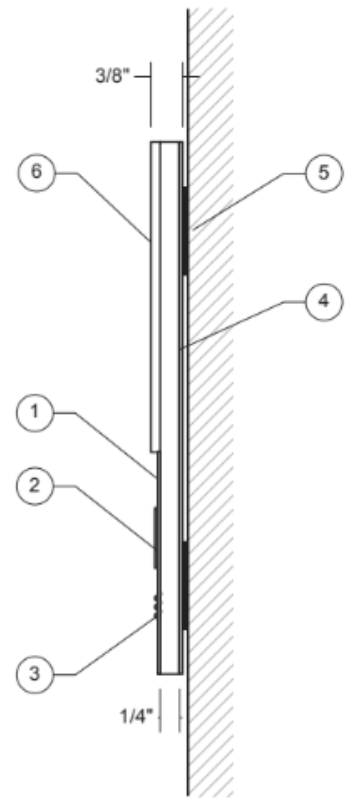

**Section**  
SCALE: 6" = 1'-0"

**Sign B1 Specifications:**

1. Room Name and Number Panel: 1/16"-thick zinc panel with integral 1/32"-raised reverse etched text, graphics, and Grade II Braille; laminated to 3/16"-thick aluminum slab carrier. Sign surface and returns painted P1.
2. Raised text and graphics painted P2 on face of graphics only.
3. Integral Grade II Braille painted P1.
4. Mounting Panel: 1/32"-thick aluminum, sized to match face panel and painted P1.
5. Sign mounts to wall surface with 3M VHB tape and silicone adhesive.
6. Sliding Window Panel: 3/8"-thick clear acrylic with machined returns to match profile illustrated in plan section.
7. Occupant Insert: Laser printed on white card stock, by others. Provide digital template.

\*Provide full-scale sample of the above sign.

**SIGN B1-B4**

**B1**

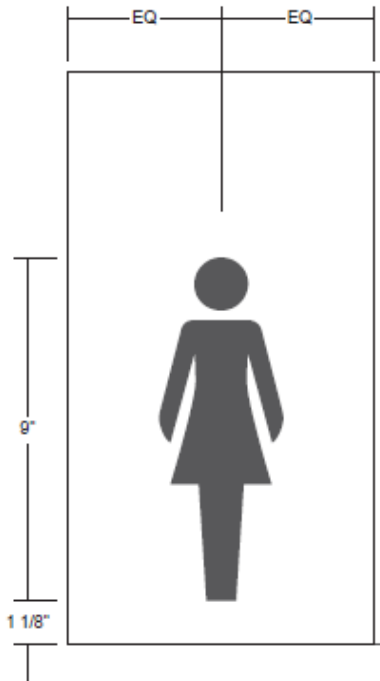

**BLADE ID: Restroom, Women**  
SCALE: 3"=1'-0"

**B2**

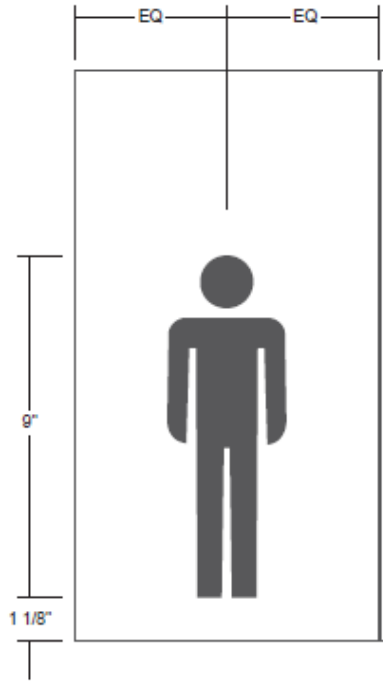

**BLADE ID: Restroom, Men**  
SCALE: 3"=1'-0"

**B3**

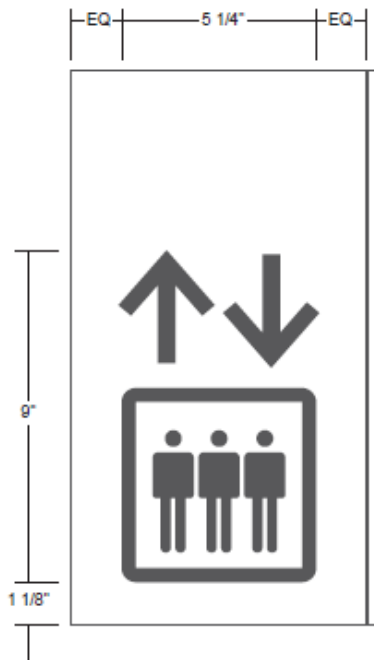

**BLADE ID: Elevator**  
SCALE: 3"=1'-0"

**B4**

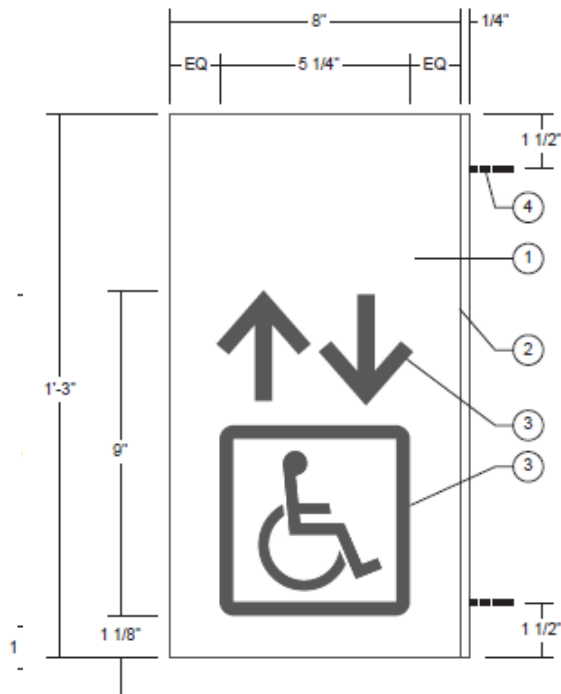

**BLADE ID: Accessible Lift**  
SCALE: 3"=1'-0"

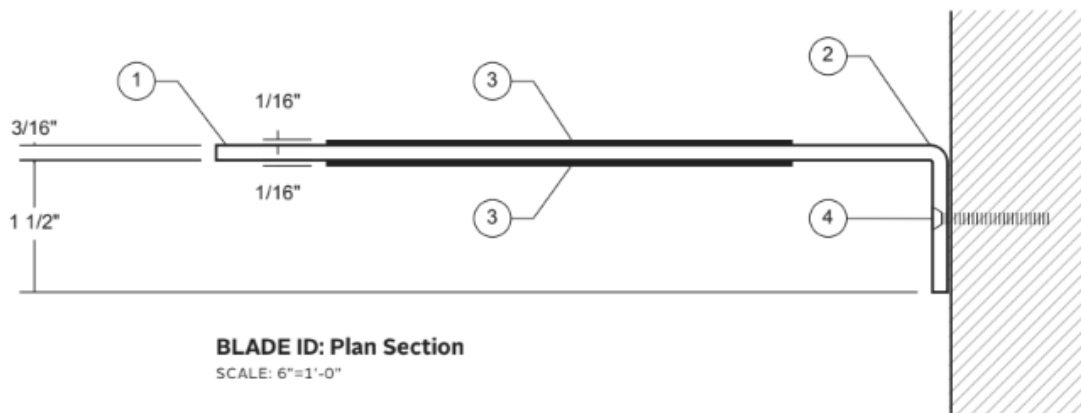

### **B1-B4 Blade Sign Specifications:**

1. Sign Panel: 3-16"-thick aluminum projecting sign panel, with identical graphics applied to both sign faces. All surfaces painted to match P1.
2. Sign panel brake-formed to a right angle "L" to enable flush mounting along the short edge, as illustrated in plan section.
3. Graphics waterjet cut from 1/16"-thick aluminum, painted P2, and epoxied to sign surfaces.
4. Sign mounts to wall surface with counter-sunk mechanical fasteners, painted P1.

## **SIGN C1 – Typical Conference Room Signage**

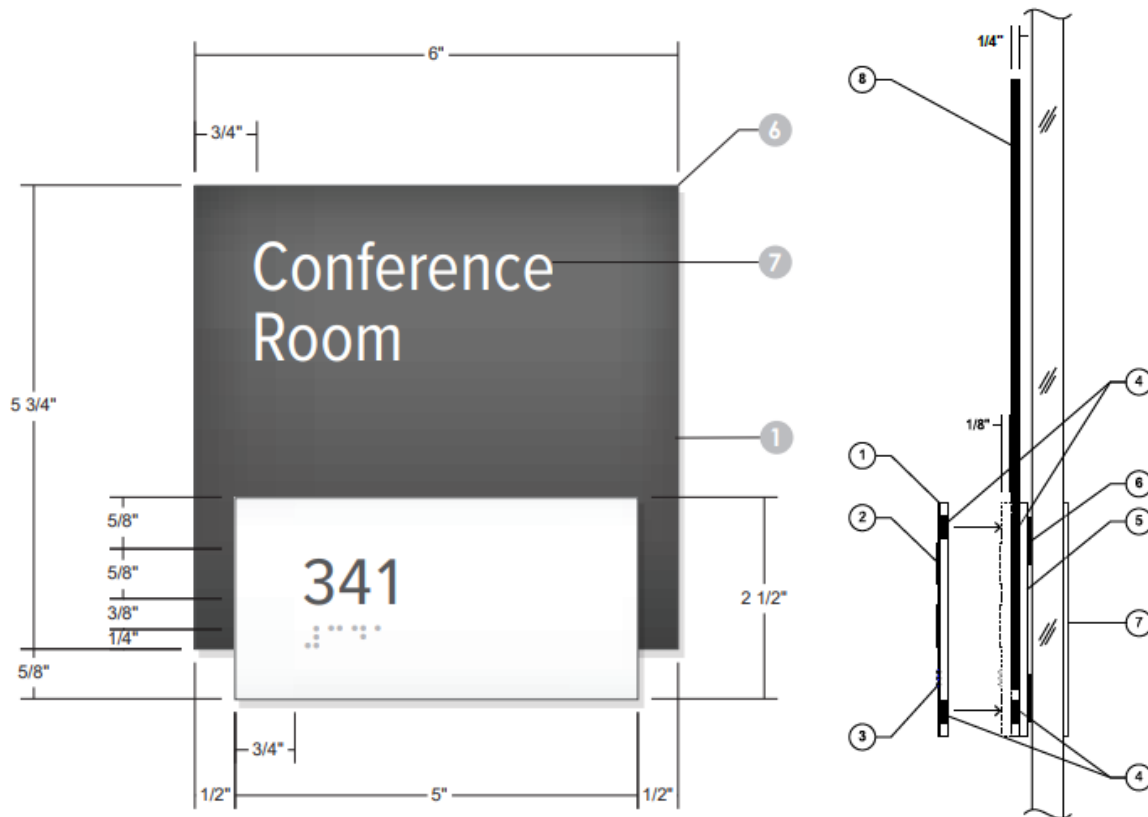

### **Sign C1 Specifications:**

- 1 Face Panel (Room Number): 1/16" thick zinc panel with 1/16" aluminum backer with integral 1/32"- raised reverse etched text, graphics, and Grade II Braille. Sign surface and returns painted P1.
- 2 Raised text and graphics painted P2 on face of graphics only.
- 3 Integral Grade II Braille painted P1.
- 4 Room Name Panel: 1/4" thick acrylic, painted P2.
- 5 Room name text first surface direct print P1.
- 6 Sign mounts to wall surface with 3M VHB tape and silicone adhesive.
- 7 Face plate attached to back plate via magnet.



## **SIGN C2**

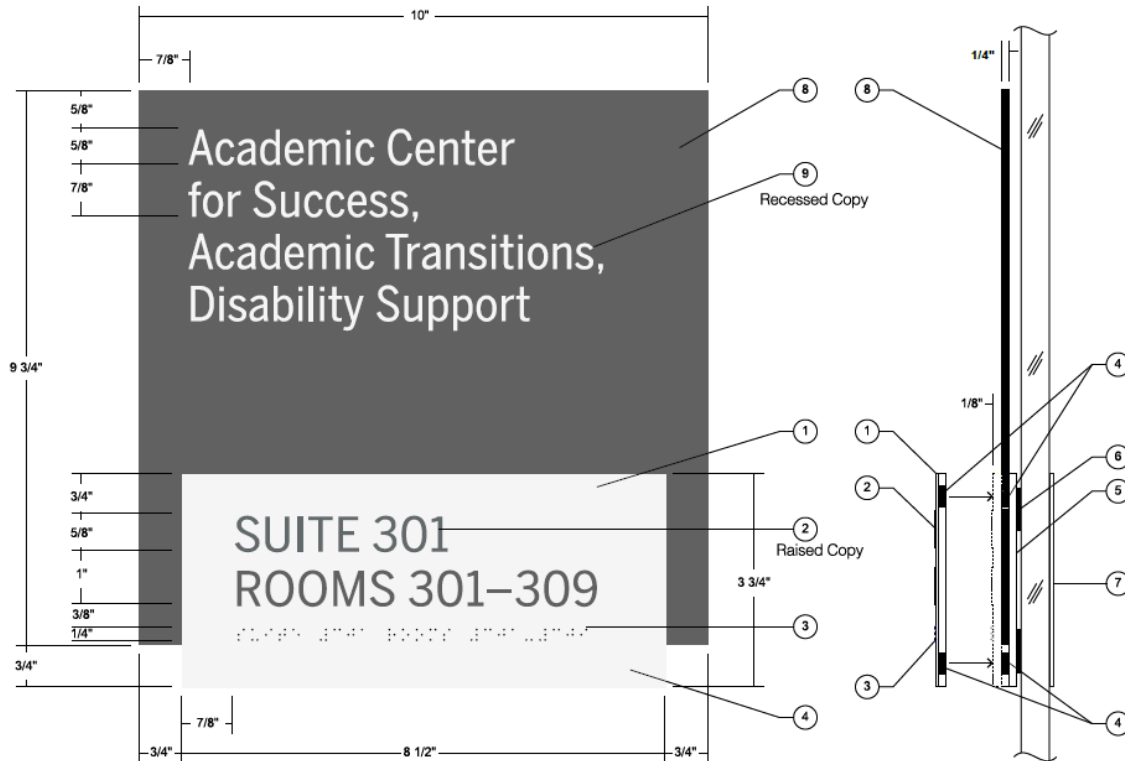

### **Sign C2 Specifications:**

1. Face Panel (suite/Room Number): 1/16"-thick zinc panel with integral 1/16"-thick zinc panel with integral 1/32"-raised reverse etched text, graphics, and Grade II Braille; laminated to 3/16"-thick aluminum slab carrier. Sign first surface and returns painted to match P1.
2. Raised text and graphics painted P2.
3. Integral Grade II Braille painted to match P1.
4. 2/8"-dia x 1/8"-thick Neodymium disc magnets adhered within pre-drilled holes in sign panels. Note: 4 magnets per face panel, one near each corner, to correspond with 4 magnets per backing panel, as illustrated.
5. Mounting Panel: 1/8"-thick aluminum, sized to match face panel, and painted P1.
6. Sign mounts to glass surface with white 3M VHB tape and silicone adhesive.
7. Glazing Backer: 1/16"-thick opaque acrylic, color P1, sized to match mounting panel, and adhered to reverse side of glazing to conceal sign mounting adhesive.
8. Changeable Room Name Panel: 1/8"-thick acrylic, with 13/32"-diameter holes drilled to align with top row of sign magnets. All surfaces painted P2.
9. Room name text first surface etched and paint infilled P1.

# SIGN D1- Directory

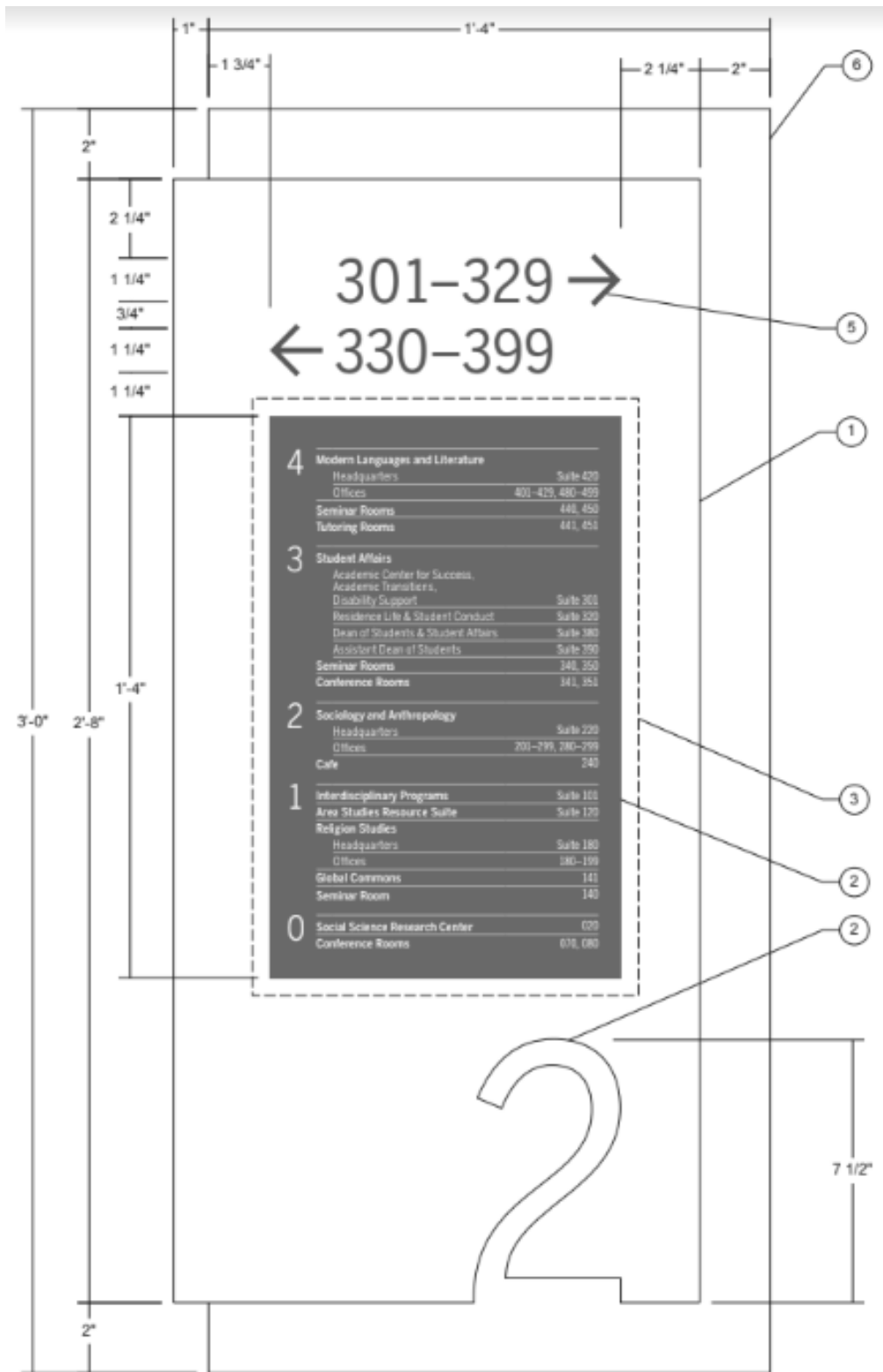

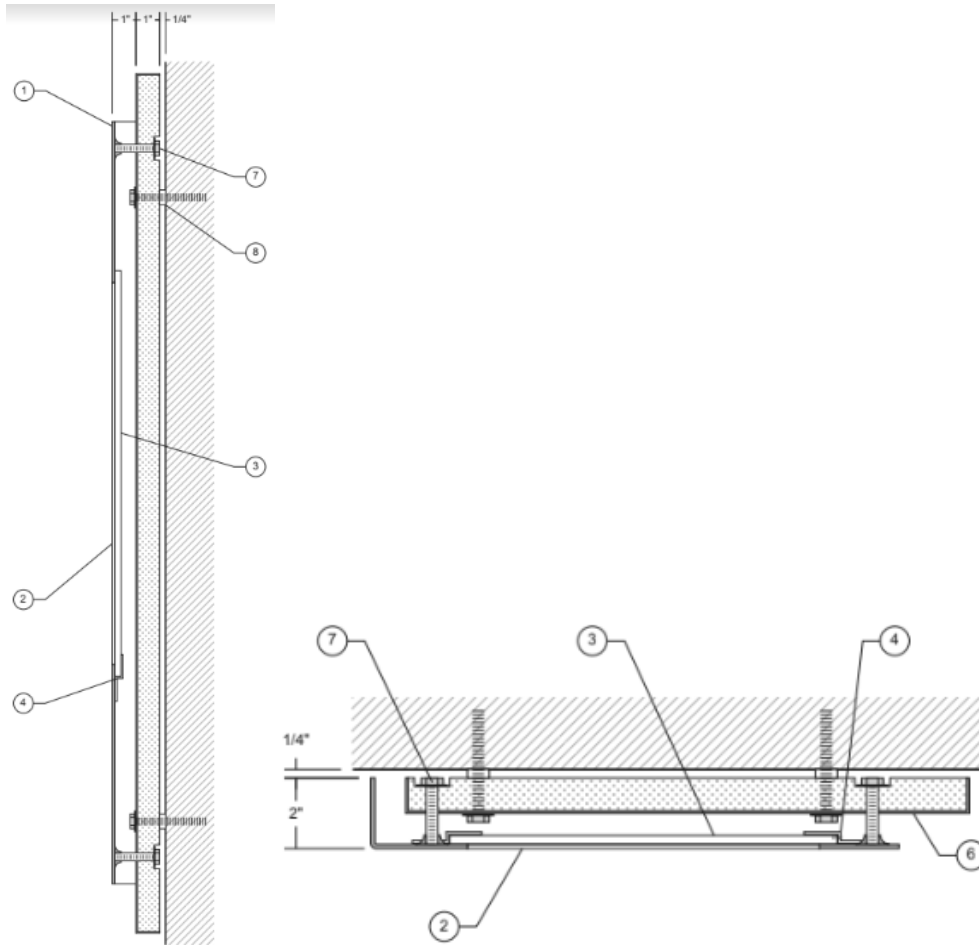

**Sign D1 Directory Specifications:**

1. Front Panel: 1/8" Aluminum panel with and chemically etched text and arrows, and brake-formed left edge (as illustrated in plan section). All surfaces and returns painted to match P1.
2. Window for Changeable Directory (10"x16") and Floor Number (7.5" tall) each waterjet cut from Front Panel. Floor Number typeset in project font and distinct for each sign (see schedule).
3. Changeable Directory Panel: 1/4" Sintra panel, 11"x17", with first surface full color digitally printed text and graphics.
4. Extruded aluminum z-channels, or similar, installed along rear surface of Front Panel to house Changeable Directory Panel. Provide set screw to secure panel.
5. Etched text and graphics paint infilled to match P2.
6. Back Panel; 18-gauge aluminum panel, satin finish, brake-formed to wrap and adhere to all exposed edges of 1" thick MDF backer.
7. Front Panel installed to stand 1" from face of Back Panel with concealed mechanical studs fasteners welded to rear face of Front Panel.
8. Back Panel installed to stand 1/4" from wall surface with concealed mechanical fasteners.

## **SIGN D2 – Changeable Insert for Directory Sign D1**

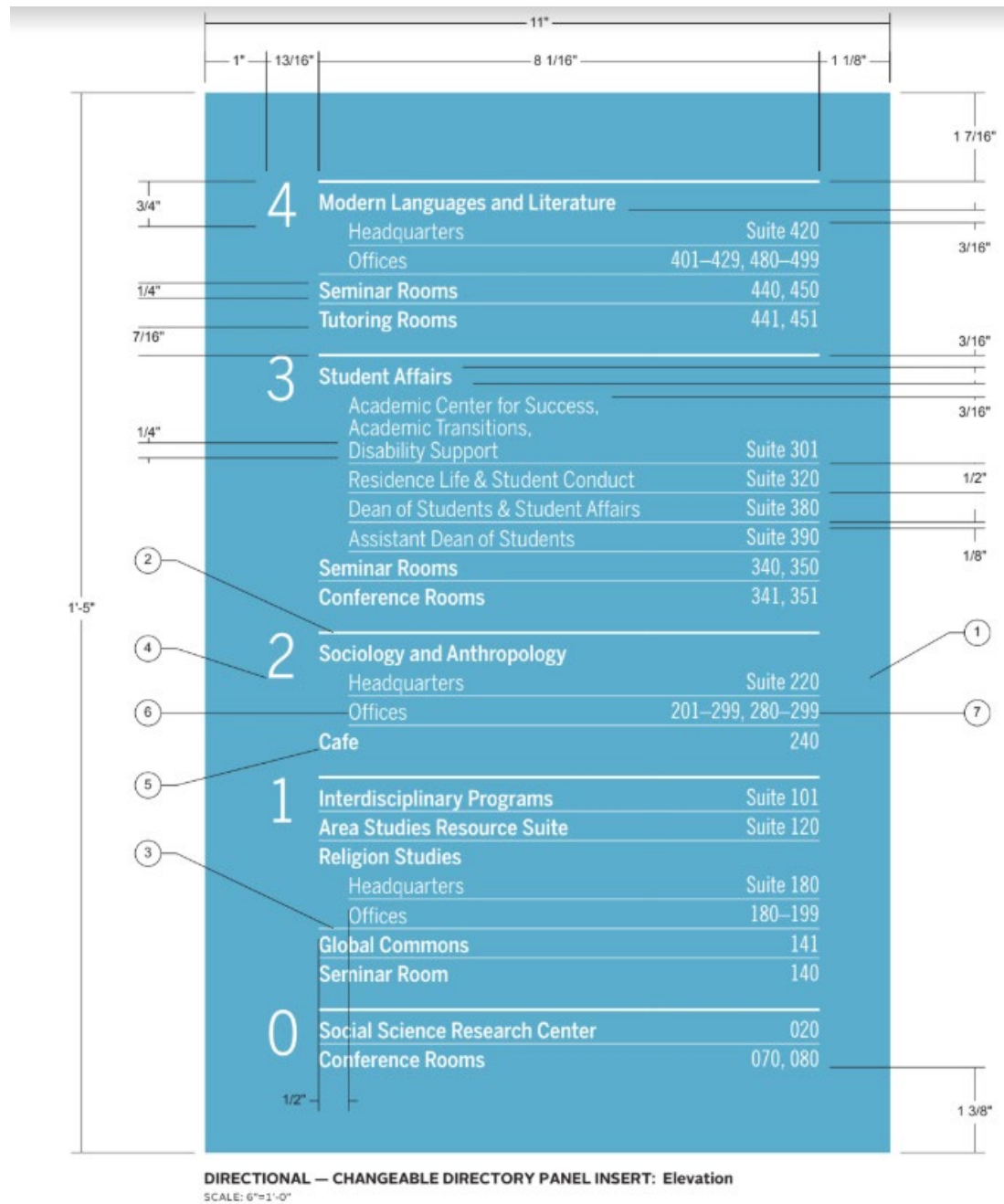

### **Sign D2 Specifications:**

1. Background: Printed in full color in P2.
2. Heavy Rule: 3-pt rule, color P1, atop floor designations.
3. Light rule: 0.5-pt rule, color P1, dividing departments.
4. Floor Number: Project Font in Book weight, color P1.
5. Department Headings: Project Font in Medium weight, color P1, text left aligned ragged right.
6. Sub-Department Headings: Project Font in Book weight, color P1, text indented, left aligned ragged right.
7. Room Number Destinations: Project Font in Book weight, color P1, text right aligned.

← 001-049  
050-099 →

<b>4</b>	<b>Modern Languages and Literatures</b>	
	Department Office	Suite 430
	Faculty Offices	Suites 431, 432, 433, 434
	Seminar Rooms	441, 432
	<b>Center for Academic Success</b>	
	Center for Academic Success	Suite 411
	Tutoring Room	431
<b>3</b>	<b>Student Affairs and Dean of Students</b>	
	Academic Support Services	Suite 301
	Residence Life & Student Conduct	Suite 320
	Student Affairs	Suite 340
	Dean of Students	Suite 350
	Seminar Rooms	342, 330
	Conference Rooms	341, 301
<b>2</b>	<b>Sociology and Anthropology</b>	
	Department Office	Suite 290
	Faculty Offices	Suites 291, 292, 293, 294
	Global Cafe	290
<b>1</b>	<b>Interdisciplinary Programs</b>	
	Administration	Suite 101
	Faculty Offices	Suite 120
	Research and Seminar Rooms	130, 140
	Global Commons	141
	<b>Religion Studies</b>	
	Department Office	Suite 180
	Faculty Offices	Suites 181, 171
<b>LL</b>	<b>Center for Community Engagement</b>	Suite 020
	Conference Rooms	030, 040

## **SIGN D3 - Directional Signage**

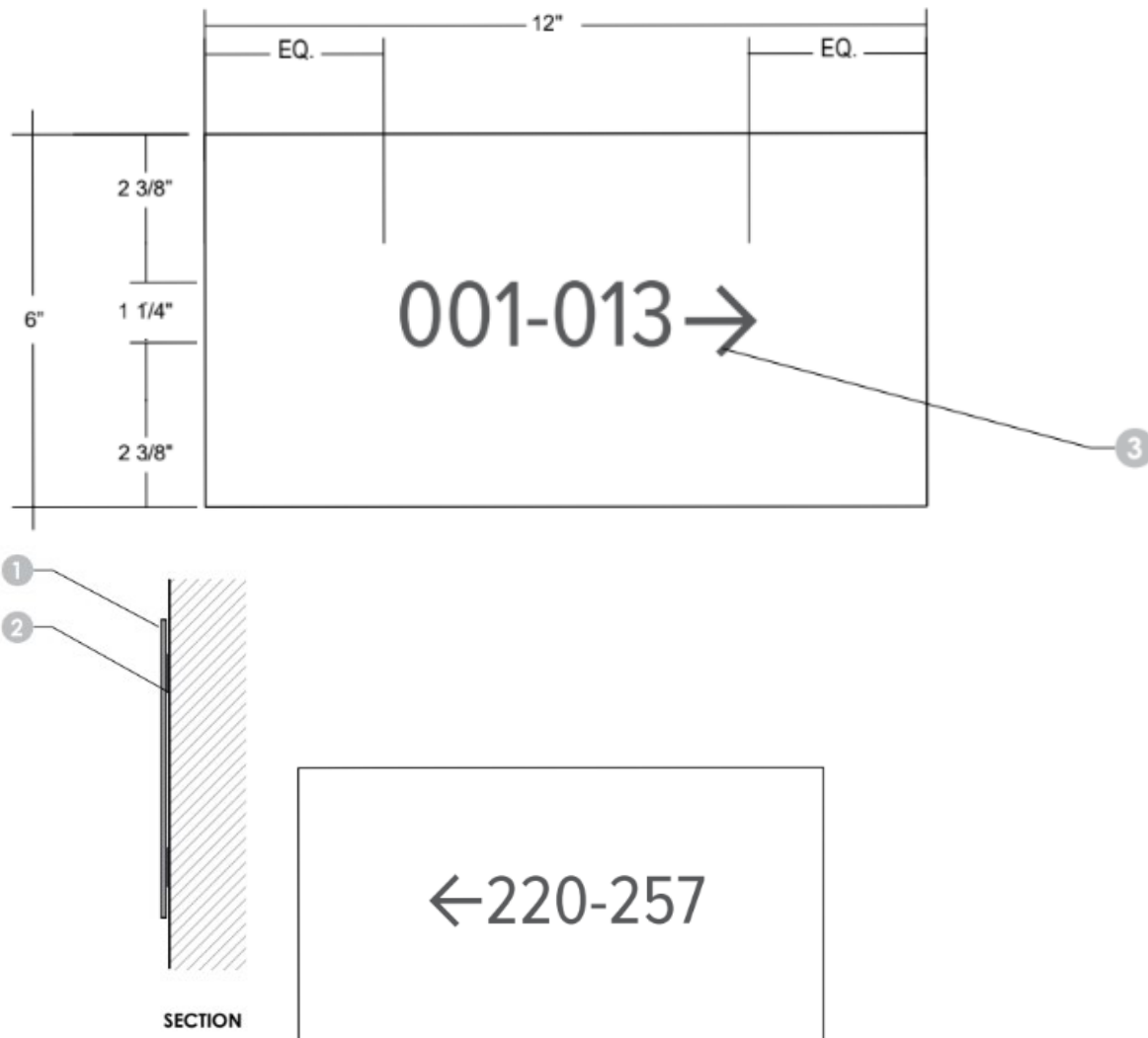

### **Sign D3 Specifications:**

1. Sign Panel: 1/8" aluminum panel. All surfaces and returns to be painted P1.
2. Sign mounts to wall surface with white 3M VHB tape and silicone adhesive.
3. Etched text and graphics paint-infilled P2.

## **SIGN E1– In Case Of Fire Signage**



### **Sign E1 Specifications:**

- 1 Sign Panel: 3/16"-thick aluminum panel with chemically etched text and graphics. Sign surface and returns painted P1.
- 2 Etched text and stair graphics paint infilled P2.
- 3 Flame graphic paint infilled to match P3.
- 4 Sign mounts to wall surface with 3M VHB tape and silicone adhesive.

## **SIGN F1 Floor ID Sign**



### **Sign F1 Specifications:**

1. Sign Panel: 1/16"-thick zinc panel with integral 1/32"-raised reverse etched text, graphics, and Grade II Braille; laminated to 3/16"-thick aluminum slab carrier. Sign surface and returns painted P1.
2. Etched text and stair graphics paint infilled to match P2.
3. Sign mounts to wall surface with white 3M VHB tape and silicone adhesive.



## **SIGN R1 – Typical Restroom Signage**

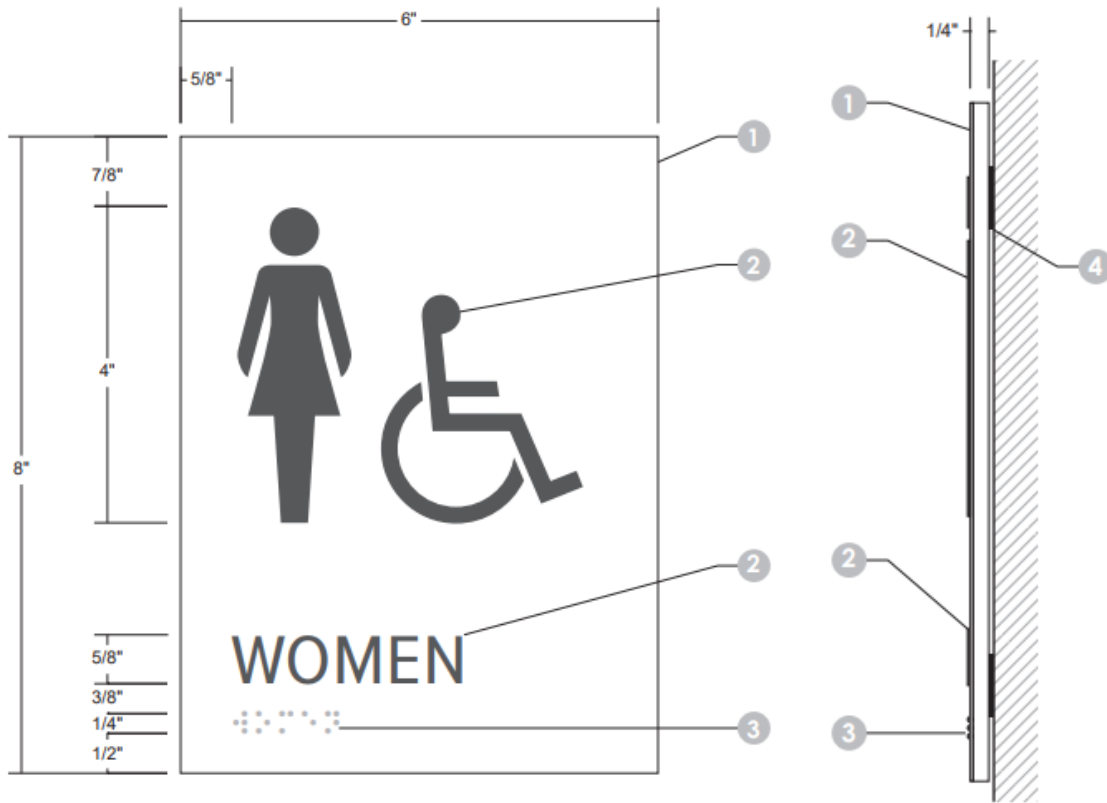

### **Sign R Specifications:**

1. Permanent Room Number Panel: 1/16"-thick zinc panel with integral 1/32"-raised reverse etched text, graphics, and Grade II Braille; laminated to 3/16"-thick aluminum slab carrier. Sign surface and returns painted P1.
2. Raised text and graphics painted P2 on face of graphics only.
3. Integral Grade II Braille painted P1.
4. Sign mounts to wall surface with white 3M VHB tape and silicone adhesive

## **SIGN R2**



**SIGN**  
**R3**



**SIGN**  
**R4**



**Sign R3-R4 Specifications:**

1. Permanent Room Number Panel: 1/16"-thick zinc panel with integral 1/32"-raised reverse etched text, graphics, and Grade II Braille; laminated to 3/16"-thick aluminum slab carrier. Sign surface and returns painted P1.
2. Raised text and graphics painted P2 on face of graphics only.
3. Integral Grade II Braille painted P1.
4. Sign mounts to wall surface with white 3M VHB tape and silicone adhesive
5. Text & Braille to follow same dimensions as sign R1.

## **SIGN S1 Stair ID Sign**

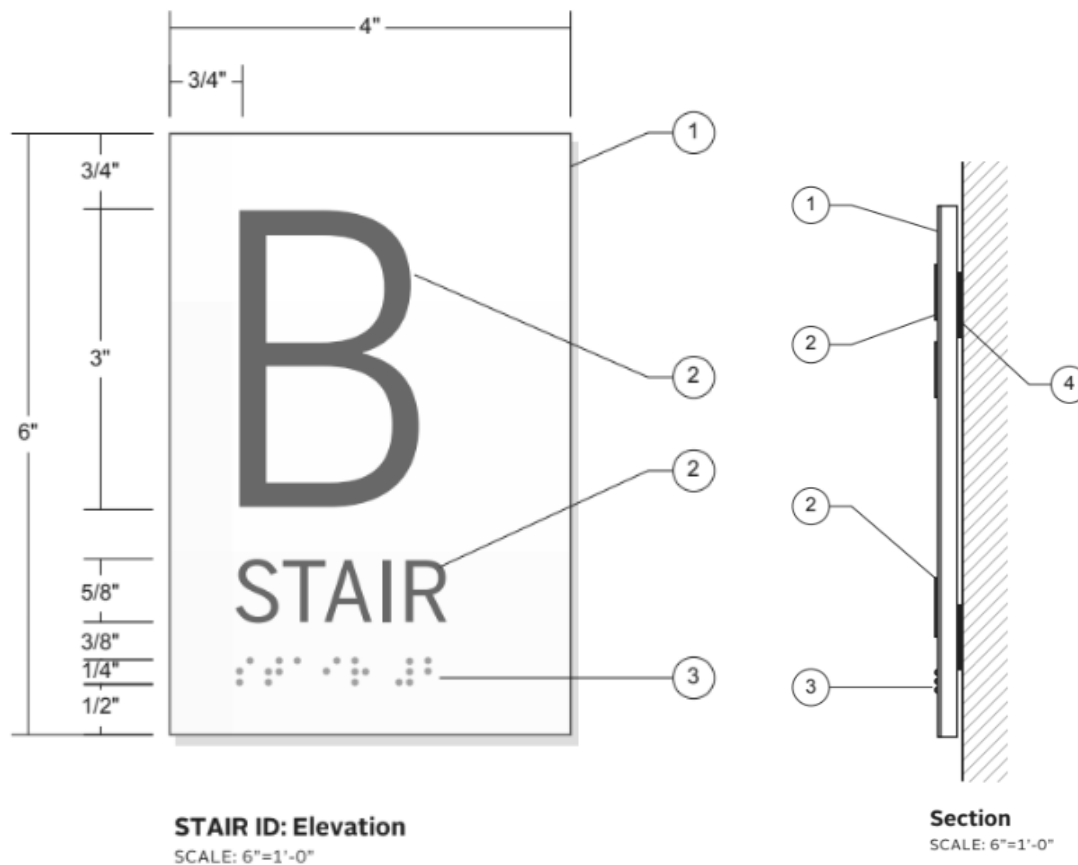

### **Sign S1 Specifications:**

1. Permanent Number Panel: 1/16"-thick zinc panel with integral 1/32"-raised reverse etched text, graphics, and Grade II Braille; laminated to 3/16"-thick aluminum slab carrier. Sign surface and returns painted P1.
2. Raised text and graphics painted P2 on face of graphics only.
3. Integral Grade II Braille painted P1.
4. Sign mounts to wall surface with 3M VHB tape and silicone adhesive.

\*Provide full-scale sample of the above sign.

## **SIGN S2 – Stair Signs at Doorways**

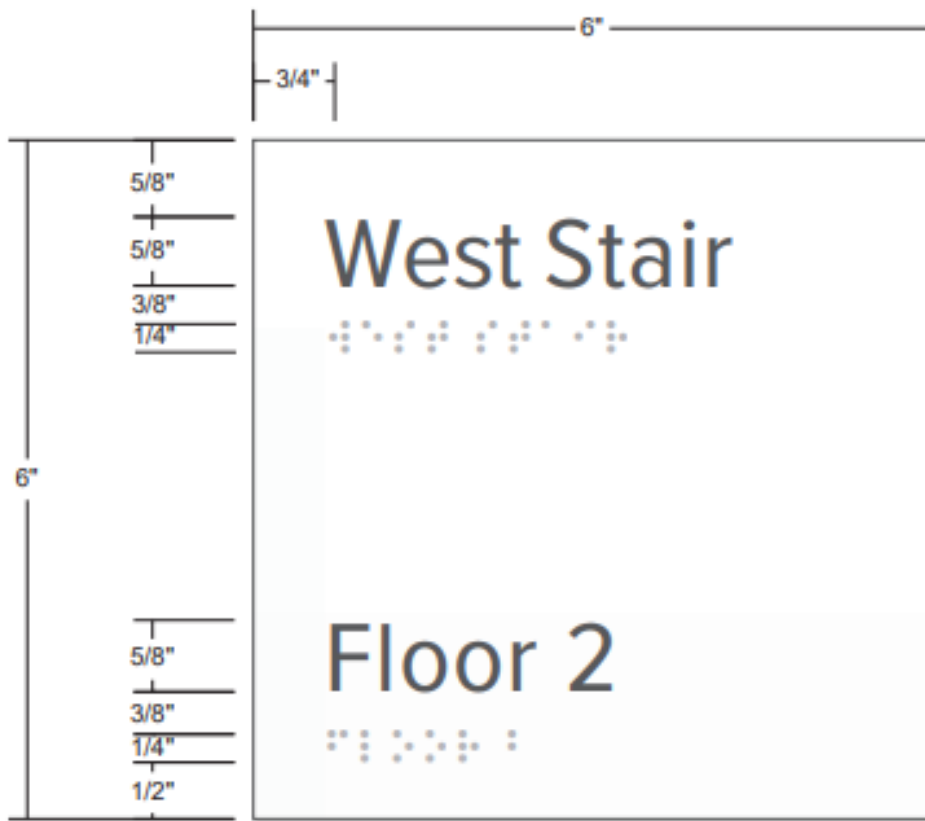

### **Sign S2 Specifications:**

1. Sign Panel: 1/16"-thick zinc panel with integral 1/32"-raised reverse etched text, graphics, and Grade II Braille; laminated to 3/16"-thick aluminum slab carrier. Sign surface and returns painted P1.
2. Etched text and stair graphics paint infilled to match P2.
- 3 Sign mounts to wall surface with white 3M VHB tape and silicone adhesive.

Project Font: Proxima Nova Condensed Regular

ABCDEFGHIJKLMNOPQRSTUVWXYZ  
abcdefghijklmnopqrstuvwxyz1234567890

Project Font (emphasis only): Proxima Nova Condensed Semibold

**ABCDEFGHIJKLMNOPQRSTUVWXYZ**  
**abcdefghijklmnopqrstuvwxyz1234567890**

Pictograms and Icons

